

Clearfield County.
Robert H. McKean

Courses & distances down
Big Mushanon from post

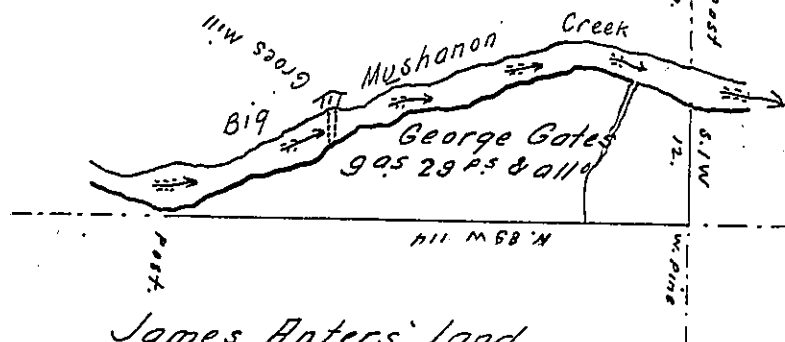

N. 75	E. 82	P. 5
N. 89	W. E. 16	"
S. 60.	E. 22	"

James Anters' land.

D. 37-46

Draft of a tract of land situate in Rush Township. Centre County.
Containing nine acres twenty nine perches and allowance of Six
per cent for roads & Surveyed the 4th day of December 1857.
by virtue of a warrant granted to George Gates dated the 6th day
of March 1857. for twelve acres.

To John Rowe Esq. }
Surveyor General }

N. J. Mitchell C. S.
Centre County.

IN TESTIMONY that the above is a copy of the original remaining on file in
the Department of Internal Affairs of Pennsylvania, made
conformably to an Act of Assembly approved the 16th day of
February, 1833, I have hereunto set my Hand and caused
the Seal of said Department to be affixed at Harrisburg,
this twenty seventh day of January 1905.

Loane B. Brown
Secretary of Internal Affairs.